



**Department of Clinical Neurophysiology
The National Hospital for Neurology and Neurosurgery**

Queen Square, London, WC1N 3BG
Tel: (020) 344 84752 Fax: (020) 7713 7743
Email: cnp@uclh.nhs.uk Web: www.ucl.ac.uk/cnp

Directions

Travel by underground or bus:

The nearest underground stations are Russell Square on the (navy blue) Piccadilly line or Holborn on the Piccadilly and the (red) Central line. The area is also served by many bus lines. Southampton Row - Bus No's 59, 68, 91, 168, 188, 501. Gray's Inn Road - Bus No's 17, 45, 46. Theobald's Road - Bus No's 19, 38, 55, 243. High Holborn / New Oxford Street - Bus No's 1, 8, 25, 98, 171, 242, 501, 521. For more information and service updates go to www.tfl.gov.uk

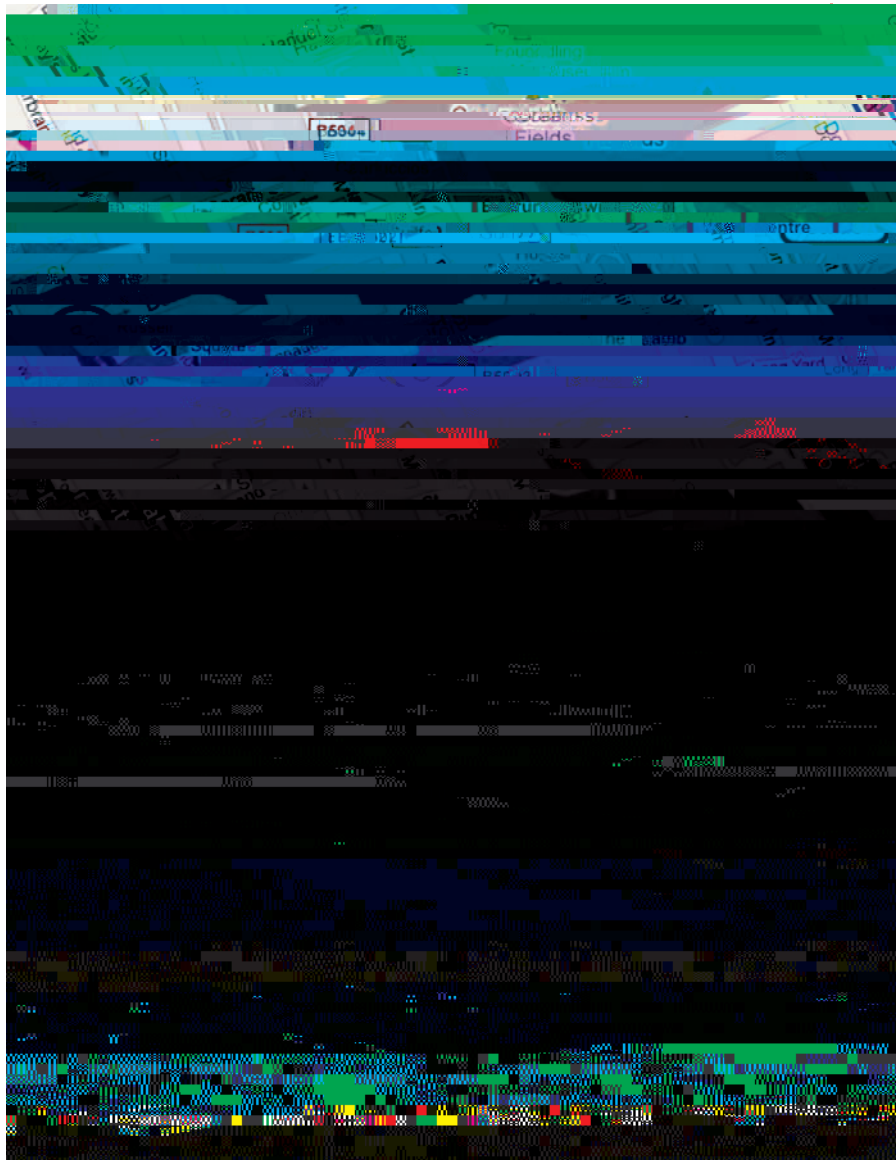

Travel by car:

Queen Square is in the central congestion charging zone. Metered parking in and around the square costs approximately £4/hour and is very limited. There are several public car parks (Brunswick Centre, Bloomsbury Square) in the area as well as car parks of nearby hotels (Imperial Hotel, Royal National Hotel) that are open to the public. For more information go to en.parkopedia.co.uk

Travel by rail:

The nearest train stations are Euston, Kings' Cross and St. Pancras International, which are about 20 minutes walking distance. From Euston there are frequent buses to Southampton Row and from King's Cross and St. Pancras International it is one stop on the Piccadilly line to Russell Square.

How to find the Department of Clinical Neurophysiology in the hospital:

We are located on the **third floor** of the **Albany wing** of the National Hospital for Neurology and Neurosurgery (NHNN).

1 Enter through the main entrance

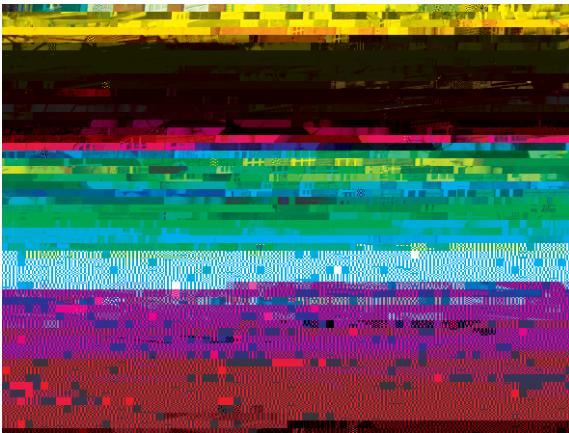

2 Turn left in the entrance hall

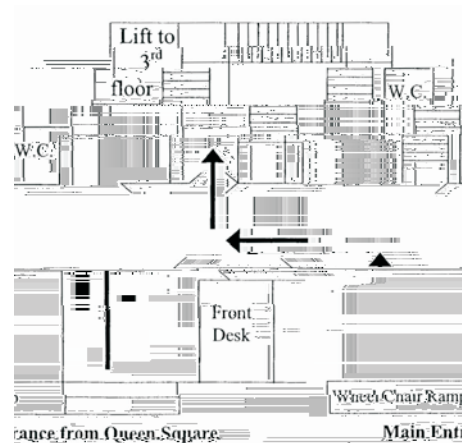
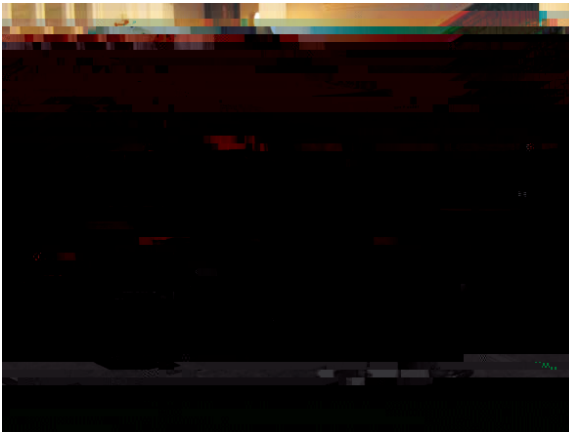

3 Take the elevator to the third floor



4 The room ahead is the reception

